

This variance, total of 47.5 sq ft (only 0.8% of the total lot size) will:

- 1) Allow the residents of a four-bedroom duplex park their vehicles safely off street, leaving more on-street parking available for those who need it
- 2) Provide the ability to reverse the vehicles safely in the back and avoid backing out into the busy traffic area
- 3) Eliminate the risk of further property damage (photos attached) and dangerous driving situations
- 4) Save the tree that's in the way of a currently approved parking plan
- 5) Finally, remove the need for the unnecessary earth disturbance of apx. 600 sq ft to otherwise satisfy City's lot coverage requirements (replacing the asphalt in the shared driveway with a ribbon driveway)

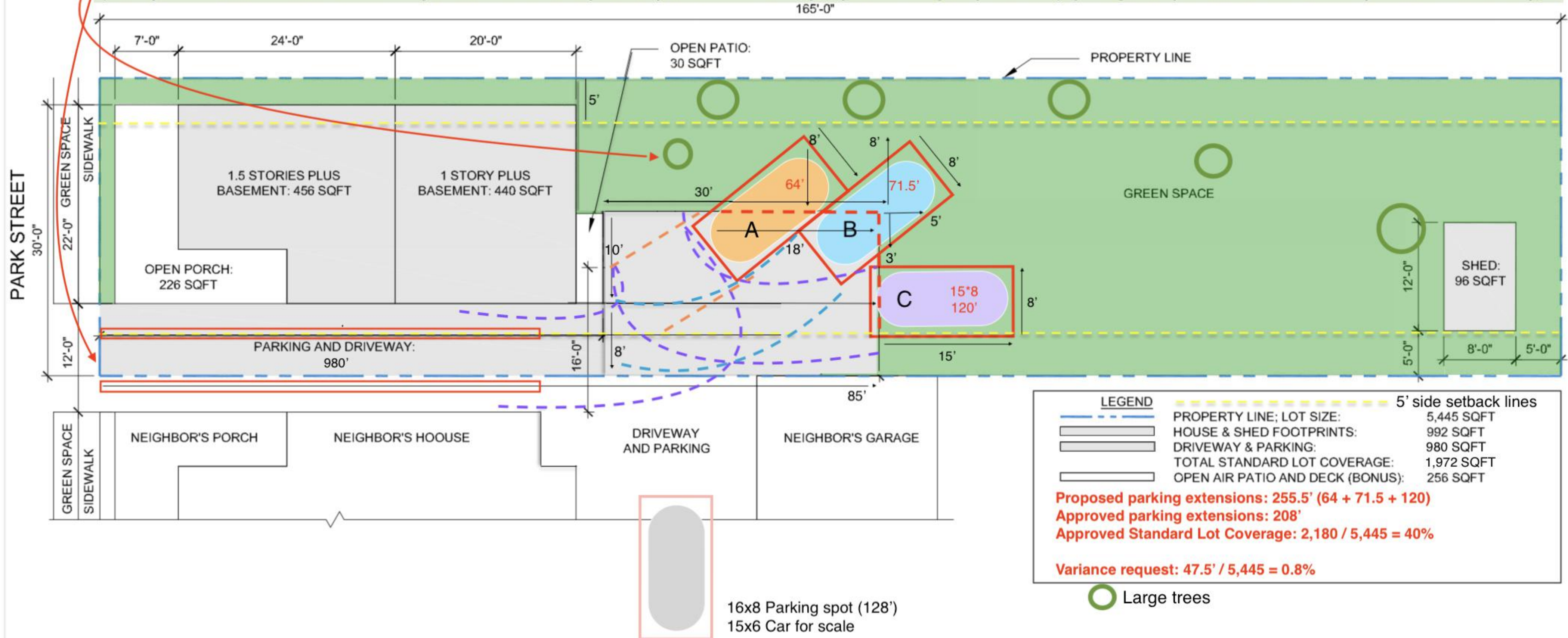

SITE PLAN

170 PARK STREET, BURLINGTON, VT

