

PROGRESS SET
NOT FOR
CONSTRUCTION

326 COLLEGE ST.
Jannef holdings Burlington, VT

revisions
date: 020823

landscape
plan
scale: 1"=10'-0"

L100

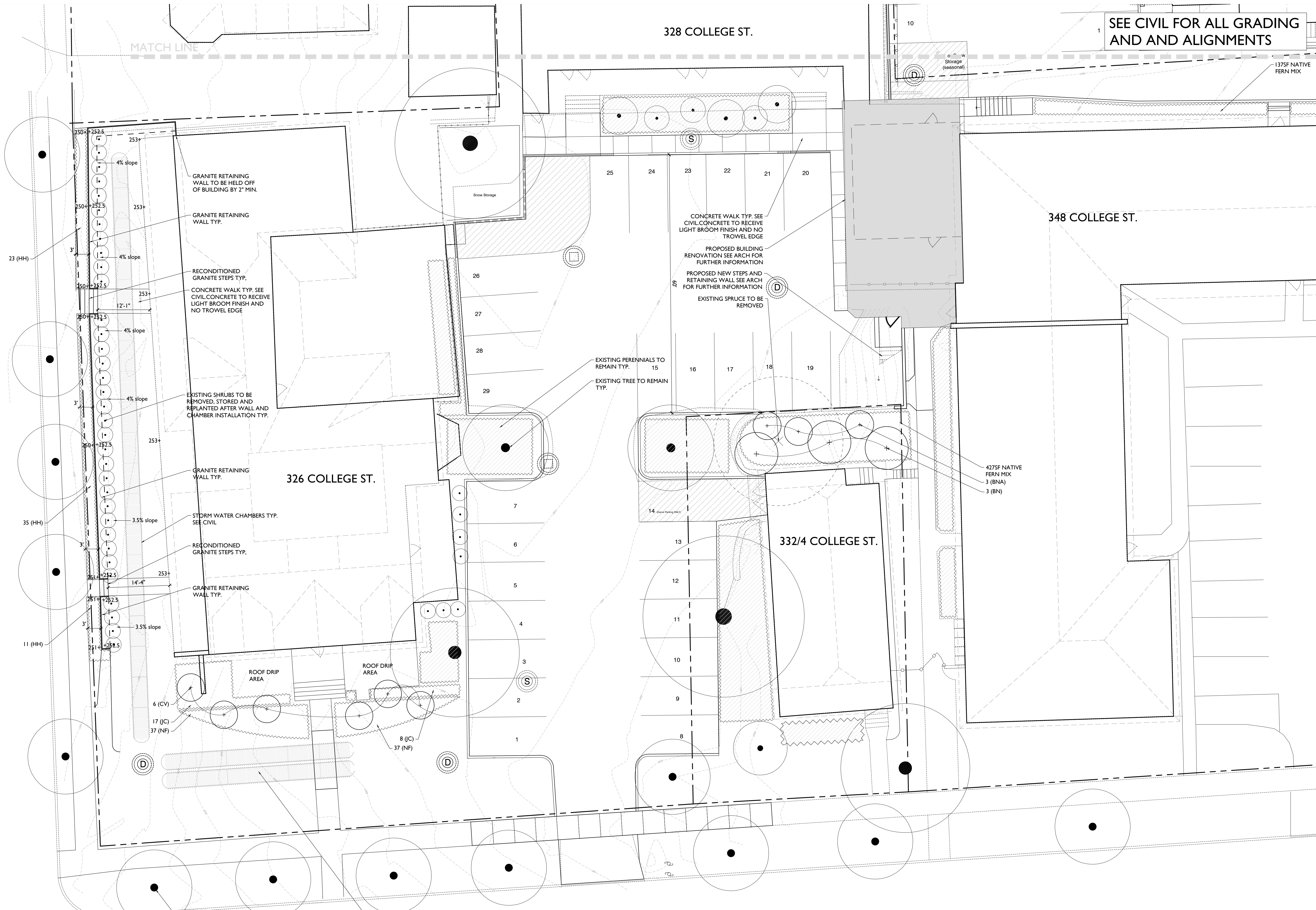

328 COLLEGE ST.

SEE CIVIL FOR ALL GRADING
AND AND ALIGNMENTS

348 COLLEGE ST.

326 COLLEGE ST.

332/4 COLLEGE ST.

College Street

PLANT SCHEDULE						326 College St. Burlington, Vermont 02.08.23	
SYM	QTY	SCIENTIFIC NAME	COMMON NAME	SIZE	SPACING	COMMENTS	
HH	69	Hemerocallis Sp.	Daylily	#1	24" OC		
NF	74	Nepeta Fassinii 'Walkers low'	Walkers low catmint	#1	24" OC		
JC	25	Juniperus chinensis var. parsonii	Parsons juniper	#3	36" OC		
BNA	7	Betula nigra	Single Stem River Birch	8-10'	AS SHOWN		
BN	6	Betula nigra	Single Stem River Birch	2.5" CAL.	AS SHOWN		
	1285sf	Native fern seed mix			AS SHOWN		

PLANT SCHEDULE						
SYM	QTY	SCIENTIFIC NAME	COMMON NAME	SIZE	SPACING	COMMENTS
HH	69	Hemerocallis Sp.	Daylily	#1	24" OC	
NF	74	Nepeta Fassinii 'Walkers low'	Walkers low catmint	#1	24" OC	
JC	25	Juniperus chinensis var. parsonii	Parsons juniper	#3	36" OC	
BNA	7	Betula nigra	Single Stem River Birch	8-10'	AS SHOWN	
BN	6	Betula nigra	Single Stem River Birch	2.5" CAL.	AS SHOWN	
	1285sf	Native fern seed mix			AS SHOWN	

326 College St. Burlington, Vermont 02.08.23

SEE CIVIL FOR ALL GRADING AND AND ALIGNMENTS

larix
landscape
architecture
studio

PROGRESS SET
NOT FOR
CONSTRUCTION

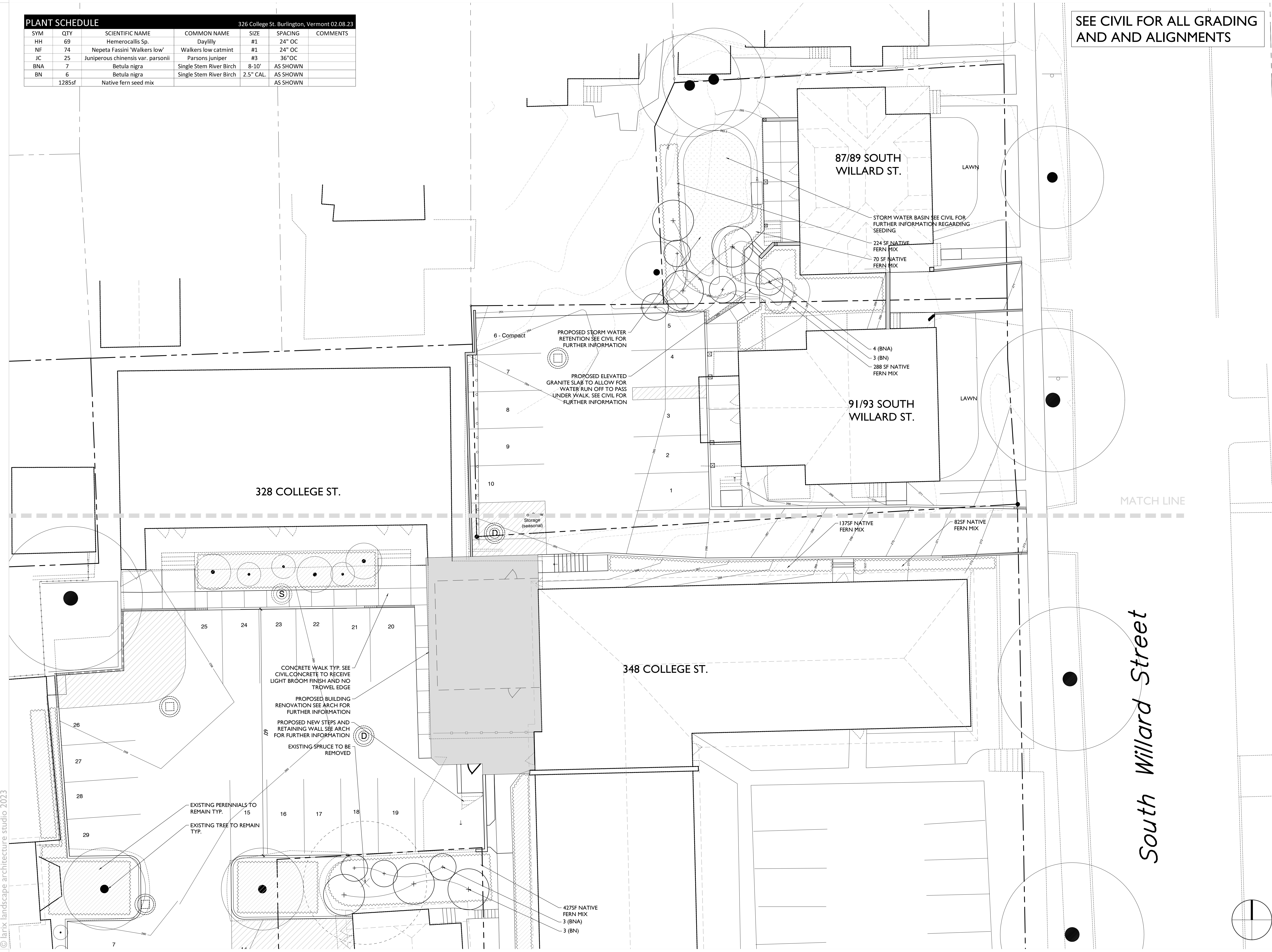

326 COLLEGE ST.
Jannef holdings
Burlington, VT

revisions
date: 020823

landscape
plan
scale: 1"=10'-0"

L100.1