

future expansion of accessible route to coffee shop - not part of this application

- RAMP
- STAIRS
- RAMP OR STAIR LANDING

NOTE: Seating layout and configuration shown for illustration purposes only. The applicant intends to utilize tables and chairs the first season to try out different layouts and seating types. Any built-in elements such as banquettes and booths, if constructed, would be built at a later date and may be configured differently than shown here.

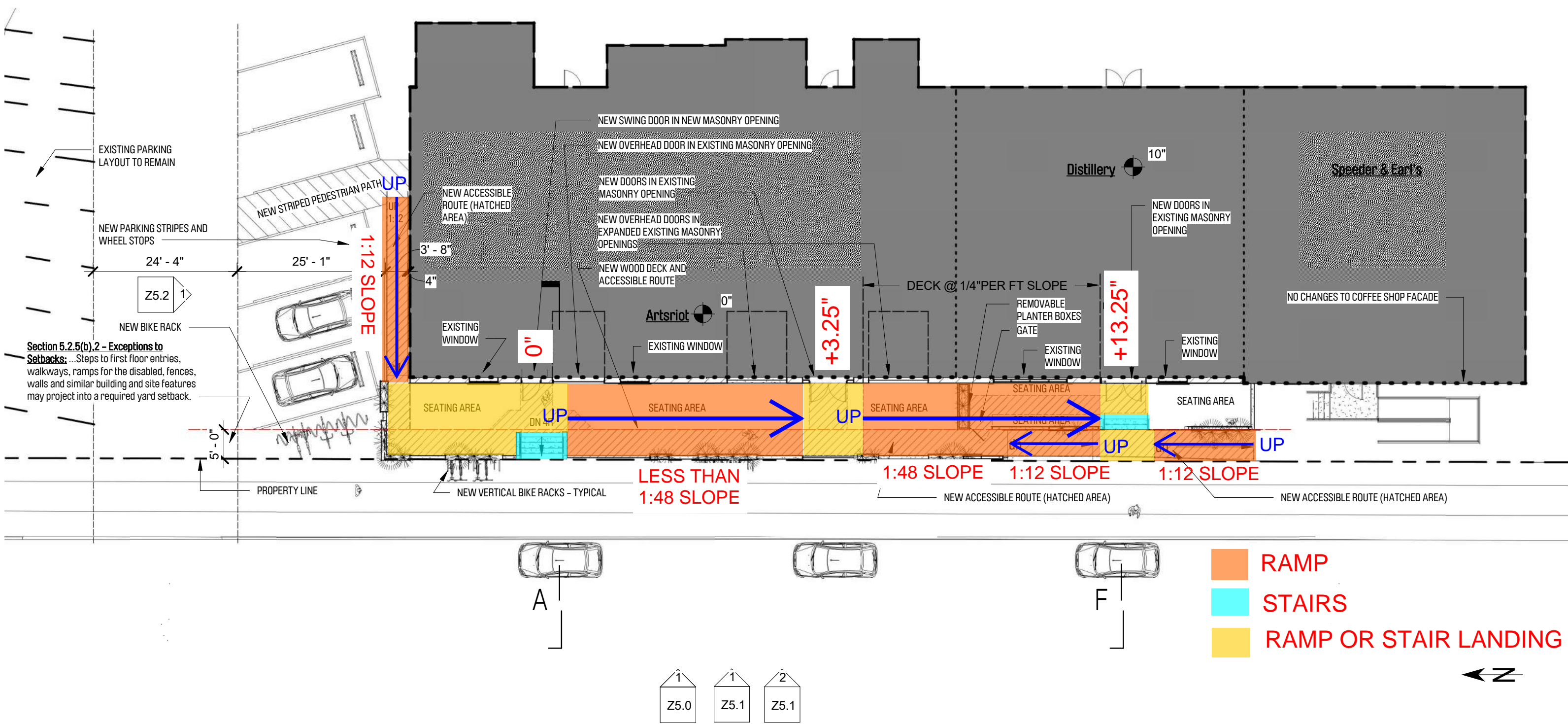

Section 5.2.5(b), 2 - Exceptions to Setbacks: ...Steps to first floor entries, walkways, ramps for the disabled, fences, walls and similar building and site features may project into a required yard setback.

- RAMP
- STAIRS
- RAMP OR STAIR LANDING

